

HALIBUT ANN

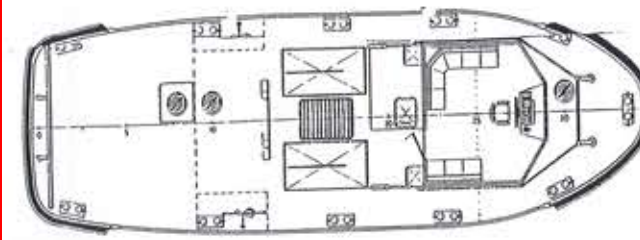

LENGTH (O.A. / B.P.) : 18.00 m / 16.79 m (59.06 ft / 55.09 ft)
 BREADTH : 5.40 m (17.72 ft)
 DEPTH : 2.32 m (7.61 ft)
 DRAFT : 1.50 m (4.92 ft)
 GRT / NRT : 34 T / 10 T
 PLACE / YEAR OF BUILD : HOLLAND LAUNCH BV / 1985
 CLASS : EMS ATTESTATION
 BOLLARD PULL : 6.40 T @ 1740 RPM
 ENGINE : TWIN SCREW ENGINE CAT 3406 DIT
 CAPACITY : TOTAL 500 BHP AT 1800 RPM
 FUEL CAPACITY: 2 X 2,00 LTRS
 SPEED : 11.04 KNOTS
 GENERATOR : 2 NOS. GENERATOR, 1 NO. 27 KVA + 18 KVA
 NAVIGATION INSTRUMENTS: VHF - RADAR
 PORT OF REGISTRY : DUBAI, U.A.E.
 REMARKS : LARGE OPEN DECK, SHALLOW DRAFT

NOTE:
ALL DETAILS ARE GIVEN IN GOOD FAITH BUT WITHOUT GUARANTEE

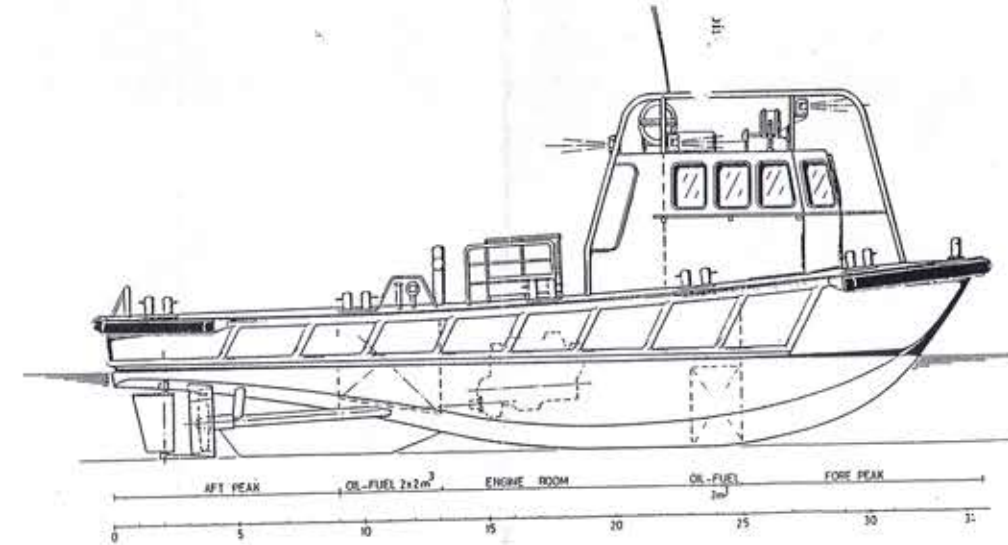

Below Maindeck

